



PROREAD™ REGISTER



INSIDE SET VERSION



PIT SET VERSION

Neptune water meters and absolute encoders form the foundation of accurate and reliable ARB® Utility Management Systems™. Since 1964 when Neptune introduced the first absolute encoder, Neptune has held firm to the philosophy that both the local visual reading and remote electronic reading should come from the same source. Today there are approximately 19 million encoders in use. Neptune guarantees the data integrity of all our absolute encoders.

The ProRead™ (ARB® VI) absolute encoder provides data integrity by encoding the actual position of the register odometer and providing error-free remote electronic meter reading capability. The ProRead encoder allows utilities to capture more reads per day, shorten billing cycles, and automate bill preparation to improve cash flow. The ProRead absolute encoder and data collection systems work together to eliminate billing discrepancies and customer complaints by providing accurate meter readings the first time, every time – guaranteeing efficiency, long-term value, and peace of mind for utilities.

ProRead is the first step toward a totally automated metering system. The ProRead register provides the actual direct reading of the register odometer and provides error-free remote electronic capability without the need for batteries. The ProRead is a fully programmable register with an ID number of up to 10 digits, three user characters, 3-6 digit meter reading and meter networking to allow connection of two registers to one remote. For reading convenience, the register can be mounted in one of four different positions on the meter bayonet. For ease of installation, the ProRead register can automatically detect 2-wire and 3-wire register protocol without programming.

PROREAD INSIDE SET VERSION

The inside set version features a non-oil-filled standard plastic polycarbonate enclosure for installation in basement or inside applications only.

PROREAD PIT SET VERSION

The pit set version features a non-oil-filled roll-sealed copper shell and glass lens housing similar to our standard direct read register housing for superior protection in a harsh pit environment.

KEY FEATURES

- Absolute encoder technology
- Available in pit and inside set versions
- Pit set version: Roll-sealed copper shell and glass lens, oil-free design, factory pre-wired and potted
- Inside set version: Plastic enclosure, oil-free design
- Error-free remote electronic reading
- Automatically detects 2-wire and 3-wire register protocol
- Reprogrammable 1-10 digit ID, 3-6 digit meter reading
- Full sweep hand for testing
- Leak detection on register face
- Tamperproof seal to meter

KEY BENEFITS

- Foundation of AMR
- Accurate and reliable meter reading
- Eliminates billing discrepancies and customer complaints
- Allows the capture of more reads per day
- Shortens billing cycle
- Automates bill preparation to improve cash flow

REGISTRATIONS AND REGISTER CAPACITY

Meter Size	4 and 6 -Wheel Encoded Odometers								
	Gallons (U.S. & Imperial)			Cubic Feet (ft ³)			Cubic Metres (m ³)		
	4-Wheel	6-Wheel	Fixed Zero	4-Wheel	6-Wheel	Fixed Zero	4-Wheel	6-Wheel	Fixed Zero
5/8", 3/4", 1"	1234	123455	0	1234	123455		1234	123455	-
1 1/2"	1234	123455	00	1234	123455	0	1234	123455	-
2", 3", 4"	1234	123455	00	1234	123455	0	1234	123455	-
6", 8", 10", 12"	1234	123455	000	1234	123455	00	1234	123455	0
16", 20"	1234	123455	0000	1234	123455	000	1234	123455	00

Some other special resolutions available upon request.

INSIDE SET VERSION

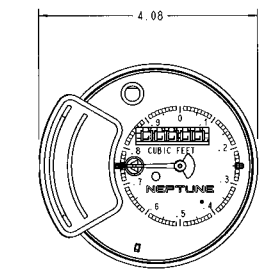

TOP VIEW

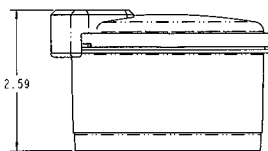

SIDE VIEW

PIT SET VERSION

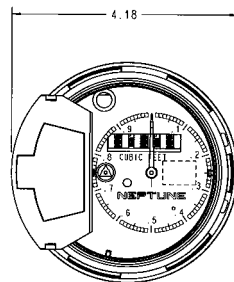

TOP VIEW

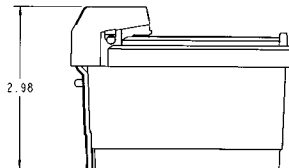

SIDE VIEW

SPECIFICATIONS

- Materials
 - Encoder register housing: Plastic Polycarbonate: inside set meters
 - Glass lens and copper can: pit set meters
 - Remote receptacles: ABS, nylon and polycarbonate
 - Connecting wire: 3-lead #22 AWG
- Distance
 - A single register may be located with up to 500 feet (152 m) of wire from receptacle.
 - Two networked registers can be located with up to 300 feet (91 m) of wire from receptacle.

OPTIONS

- Sizes
 - Available for all sizes and makes of current Neptune meters.
- Electronic Accessory Equipment
 - Advantage
 - Pocket ProReader
 - DAP Handhelds with adapter
 - R900s (Single or Dual)
- Units of Measure: U.S. Gallons, Cubic Feet, Imperial Gallons, Cubic Metres
- Environmental Conditions:
 - Operating temperature: 32°F to 158°F (0°C to 70°C)
 - Storage temperature: -40°F to 158°F (-40°C to 70°C)
 - Operating humidity: 0 to 100%

Neptune engages in ongoing research and development to improve and enhance its products. Therefore, Neptune reserves the right to change product or system specifications without notice.

Neptune Technology Group Inc.

1600 Alabama Highway 229
Tallahassee, AL 36078
USA
Tel: (800) 645-1892
Fax: (334) 283-7299

Neptune Technology Group (Canada) Ltd.

7275 West Credit Avenue
Mississauga, Ontario
L5N 5M9
Canada
Tel: (905) 858-4211
Fax: (905) 858-0428

Neptune Technology Group Inc.

Ejército Nacional No. 418
Piso 12, Desp. 1201-1202
Col. Chapultepec Morales
Delegación Miguel Hidalgo
11570 México, Distrito Federal
Tel: (525) 55203 5294 / (525) 55203 5708
Fax: (525) 55203 6503



NEPTUNE
TECHNOLOGY GROUP

neptunetg.com